

Bolt matrita

Pentru S6410

S6411/ ... (CAPMM- ...)

Material: 1.3343 / 60 - 62HRc

Suprafata: cromat

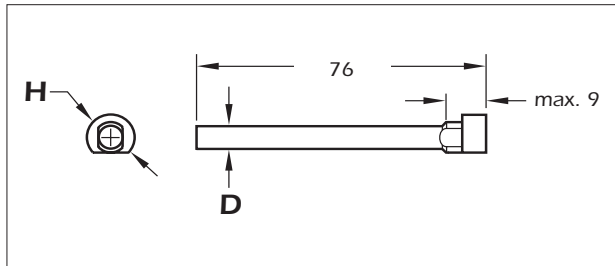

Mould Pin

For S6410

Material: 1.3343 / 60 - 62HRc

Surface: Chrome plated

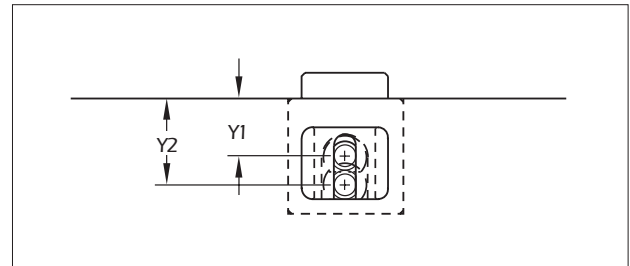

D	H	pentru/for S6410	Y1	Y2	Nr. / No.
5 ±0,005	9,5	X	12,7	19,05	S6411/ 5x76
10 ^{-0,008} _{-0,016}		X		17,4	10x76

Extensie

Pentru S6410

S6412/ ... (CAPEMM- ...)

Material: 1.7225

Suprafata: brunat

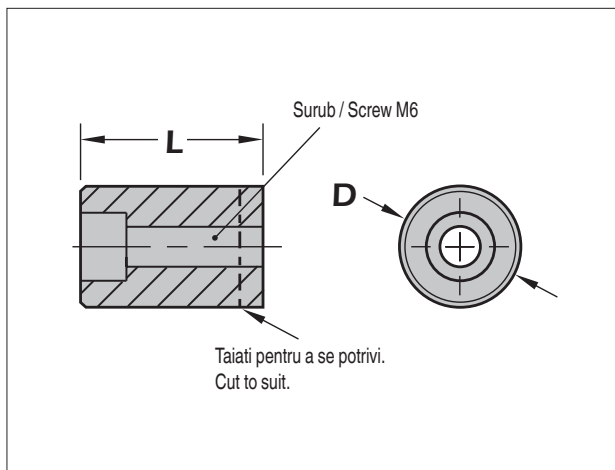

Extension

For S6410

Material: 1.7225

Surface: Blackened

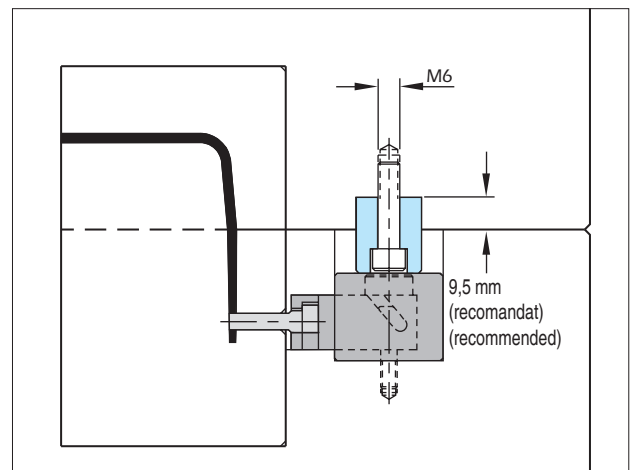

D	pentru/for S6410	L	Nr. / No.
19	X	28	S6412/ 19x28